

sola thermostatic concealed shower valves

antiscald failsafe technology
thermostatic control
ergonomic operation

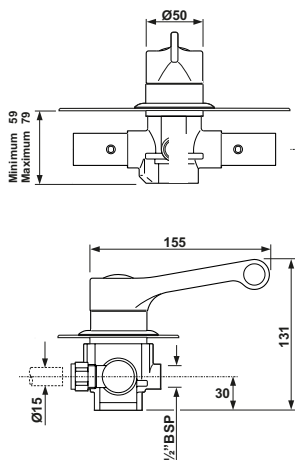

sola thermostatic shower valve - concealed



to specify/order:

Please use the product reference shown below.

thermostatic shower valve

Concealed valve **SF1137CP**
Concealed valve
inc. Wall Outlet Elbow **SF1555CP**

shower rail

Sola Shower rail, hose & head **SF1256CP**
- single function, smooth hose
Sola Shower rail, hose & head **SF1261CP**
- multi function, braided hose

finish

Chrome plated CP.

approvals

HBN 00-10 C, code (TM1)
WRAS Approved



system requirements

Suitable for use with unvented supplies, combi boilers, gravity and mains pressure systems.

recommended operating pressure

Max Inlet pressure static 10 Bar.
Max recommended dynamic pressure 5 Bar.
Min operating pressure dynamic 0.2 Bar.
Max unbalanced pressure ratio 5:1.
Inlet connections 15mm.
Outlet connections 1/2".
Max inlet temperature 85 °C.
Min Temp differential to ensure failsafe between hot and cold supplies 10 °C.

note

Pre-set factory temperature setting 38 °C.
Suitable for use with unvented supplies, combi boilers, gravity and mains pressure systems.

Sola TMV3 Shower Valve, Concealed - SF1137CP & SF1555CP

| Pressure | 0.5 Bar | 1 Bar | 2 Bar | 3 Bar | 4 Bar | 5 Bar |
|-------------------------------|---------|-------|-------|-------|-------|-------|
| Flow Rate (Litres per minute) | 8.6 | 10.5 | 15.2 | 18.8 | 22.6 | 24.5 |



Hotels



Education



Commercial



Residential



Less Able

Twyford

Geberit Group

144